



**OFFICE OF THE COLLECTOR & DISTRICT MAGISTRATE,  
KALAHANDI (ODISHA).**

No. 293 /Res (COVID-19 Cell).

Date. 9<sup>th</sup> April, 2021.

**ORDER**

Whereas the Govt. of Odisha vide R&DM (DM) Deptt. Notification No. 1706/ R&DM (DM), dated 13.03.2020 has declared COVID-19 as a "Disaster" under section 2 (d) of the Disaster Management Act, 2005 for the state of Odisha and promulgated Odisha COVID-19, Regulation 2020 by virtue of the power conferred under section 2, 3 and 4 of Epidemic Disease Act, 1897 for containment of COVID-19.

And whereas, the National Disaster Management Authority, Govt. of India in exercise of Powers conferred u/s 6(2) (i) of the Disaster Management Act 2005 has directed the State Govt./ State Authorities to take measures for ensuring social distancing so as to prevent the spread of COVID-19 and directed the national Executive Committee under the said act to issue necessary guidelines in this regard.

And whereas, the Govt. of Odisha has directed the local Authorities vide Order No. 1020/ R & DM (DM) Date.27.02.2021 to carefully demarcate the containment zones in accordance with the guidelines of MoHFW, Govt. of India/ H & FW Department, Govt. of Odisha and notified the same.

Whereas in larger Public interest and with a view to contain the spread of COVID-19 and contact tracing for the identified case, I, Dr. Gavali Parag Harshad, IAS, Collector and District Magistrate-cum-Empowered Officer, after detection of some new COVID-19 positive cases belonging to under mentioned areas of **Manjhari** village of Manjhari GP under Golamunda Block, declare as **Containment Zone** (Sketch Map enclosed) and nearby vicinity of the containment zone as **Buffer Zone** with immediate effect with following conditions:

- All Vehicular movement, movement of public transport and personnel movement will be stopped barring extremely urgent medical cases with the permission of undersigned in the containment zone.
- All inhabitants within the **Containment Zone** shall strictly remain in home. All the shopping establishments of whatsoever nature shall be closed immediately.
- All the Government and Private institutions located within the boundary of the **Containment Zone** are hereby closed forthwith.

P.T.O.

- The movement of people in **Buffer Zone** is permitted only for essential works and strictly following the social distancing norms.
- Superintendent of Police, Kalahandi will make necessary arrangement for immediate deployment of adequate Police at required Points.
- Sub-Collector, Dharamgarh will remain in overall charge.
- Tahasildar, Golamunda will be responsible for maintaining law & order.
- BDO, Golamunda will ensure supply of essential goods & Medical supplies in the Containment and buffer zone.
- CDMO, Kalahandi will ensure Contact tracing, IEC, active surveillance in Containment zone and passive surveillance in buffer zone.
- Other instructions as mentioned vide Order No. 2800/ R & DM (DM) Dated 18.05.2020 Clause-5 will be applicable *mutatis mutandis*.
- The shutdown period is effective till **Midnight of 14<sup>th</sup> April, 2021.**



Collector & Dist. Magistrate,  
Kalahandi.

Date. 9<sup>th</sup> April, 2021.

Memo No. 294 /Res (COVID-19 Cell).

Copy forwarded to the Superintendent of Police, Kalahandi/ Addl. District Magistrate, Kalahandi/ PD.DRDA, Kalahandi/ CDM & PHO, Kalahandi/ Sub-Collector & SDM, Dharamgarh/ Tahasildar, Golamunda/ BDO, Golamunda/ DEO, Kalahandi/ BEO, Golamunda / All District Level Officers for information and necessary action.



Collector & Dist. Magistrate,  
Kalahandi.

Date. 9<sup>th</sup> April, 2021.

Memo No. 295 /Res (COVID-19 Cell).

Copy to DIO, NIC, Kalahandi for uploading the same in the Kalahandi District portal for wide publicity of the Order.



Collector & Dist. Magistrate,  
Kalahandi.

Date. 9<sup>th</sup> April, 2021.

Memo No. 296 /Res (COVID-19 Cell).

Copy submitted to the Special Relief Commissioner, Bhubaneswar for favour of kind information.

Copy submitted to the Revenue Divisional Commissioner (SD), Berhampur for favour of kind information.



Collector & Dist. Magistrate,  
Kalahandi.



PREPARED MAP FOR CONTAINMENT AREA UNDER COVID-2019 OF VILLAGE -  
MAVTHARI, PS. GOLAMUNDA.

N  
MOUZA - MAVTHARI  
PS. GOLAMUNDA.  
DIST - KAKAHANDI  
VILLAGE MAP - SHEET NO-3  
(NOT TO THE SCALE)  
S

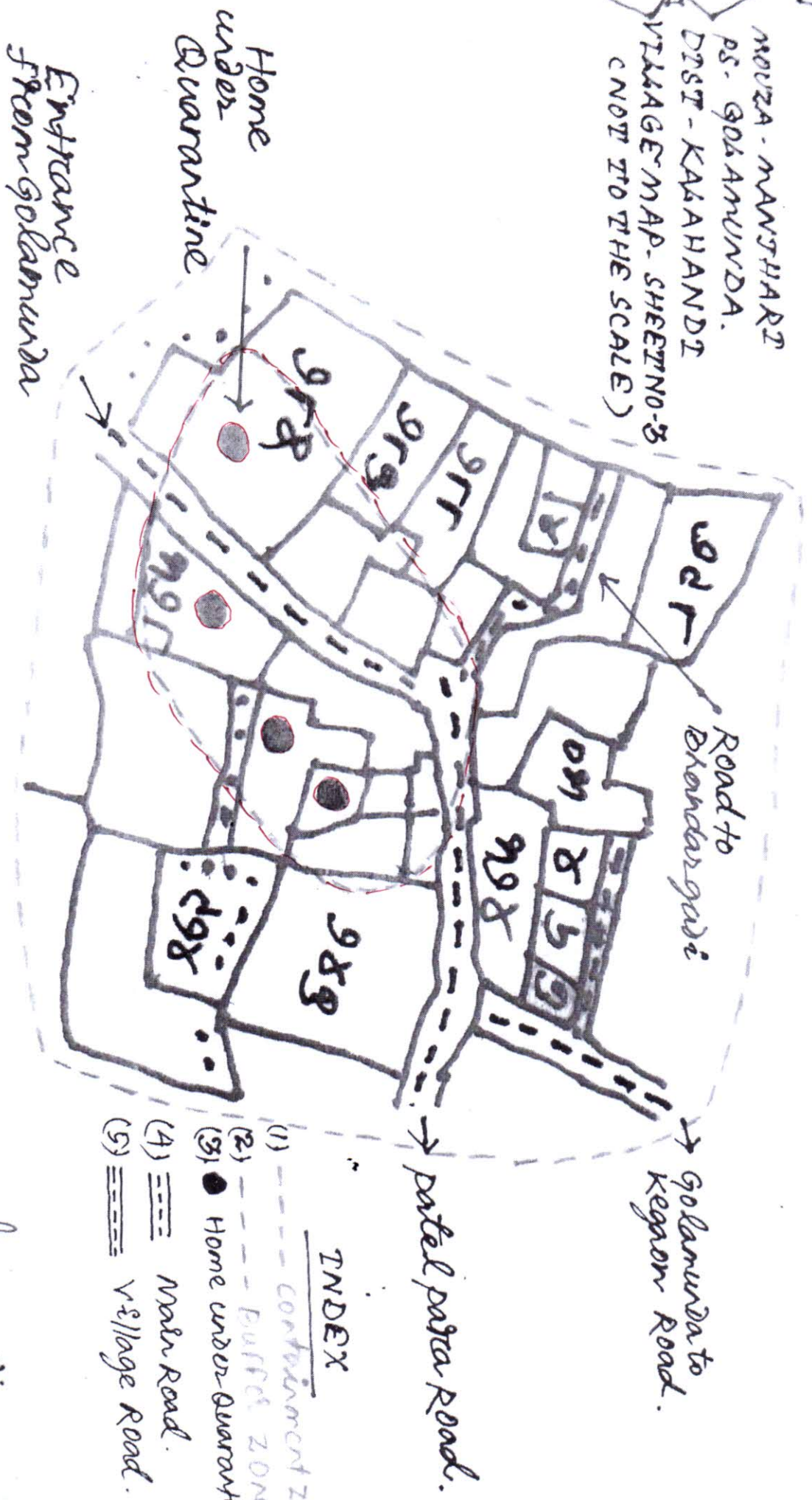

- INDEX**
- (1) --- Containment Zone
  - (2) --- Puffet Zone
  - (3) ● Home under Quarantine
  - (4) === Main Road.
  - (5) === Village Road.

TAHASILDAR  
GOLAMUNDA

REVENUE INSPECTOR  
GOLAMUNDA, K.D.

12/04/2021